

First, install the solenoid valve line: as shown below FERRARI F12 Installation Instructions

1. Yellow line: TPS throttle valve voltage signal 0-5v
2. Brown line: GND body grounding
3. Red line: power cord
4. Green Line: Crankshaft Signal (RPM)
5. Solenoid valve

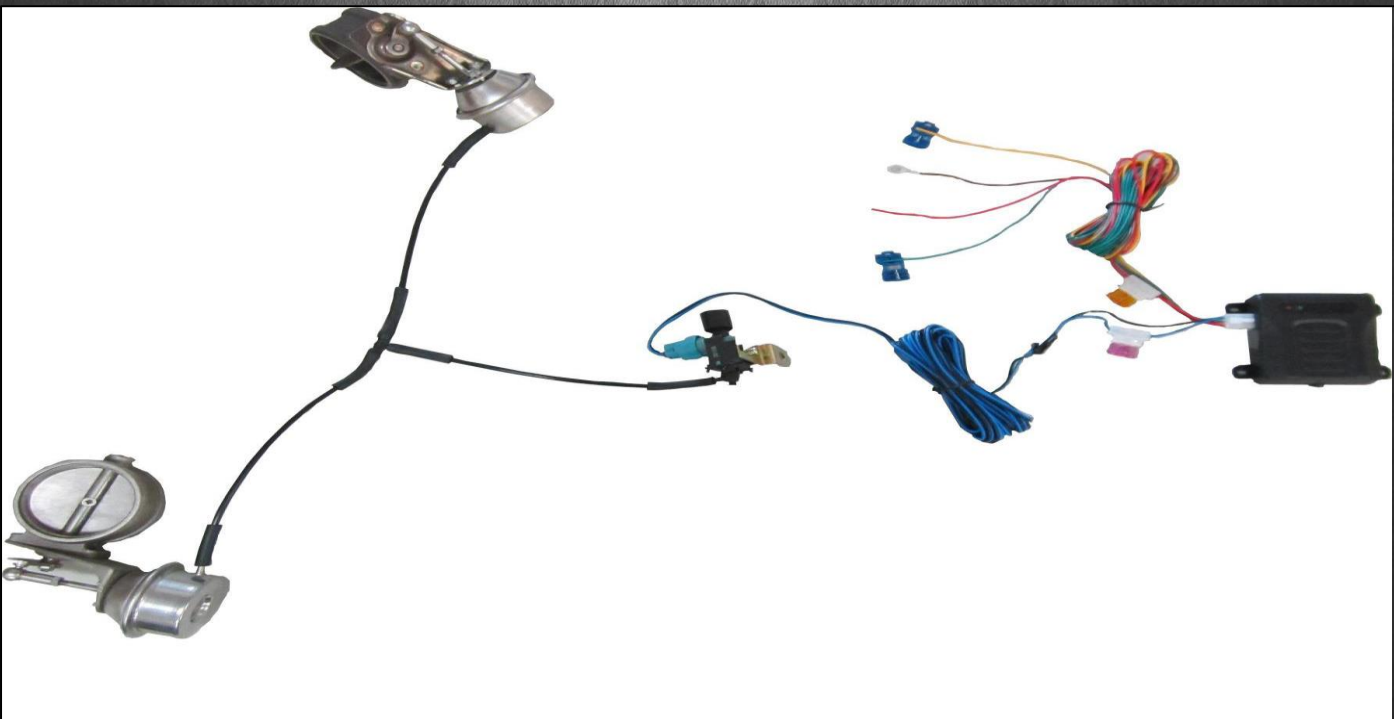

Second, the installation instructions

1. Look for the fuse box in the passenger seat and connect the red power cord.

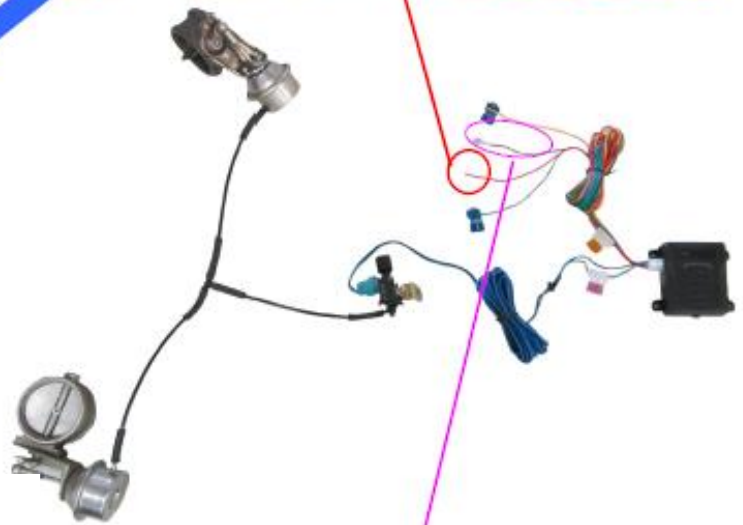

2. under the fuse box, hang up the body iron (brown line)



3. Find the yellow-green line on the accelerator pedal and connect the TPS line (yellow line)

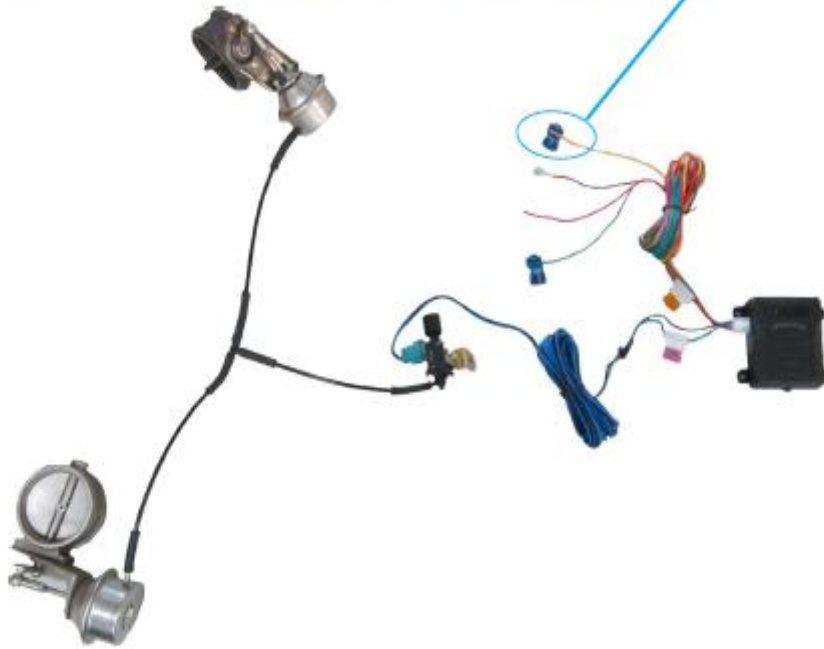

(1)

ストッパ

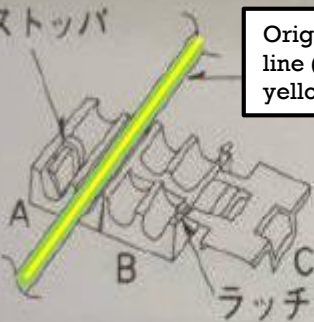

Original car line (greenish yellow)

(2)

TPS (throttle valve, yellow line)

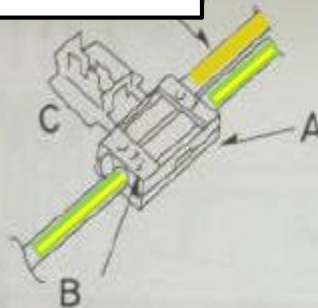

(3)

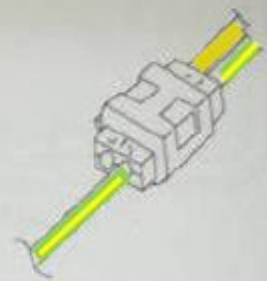

4. Look for the gray line in the engine room and connect the crank signal line (green line).

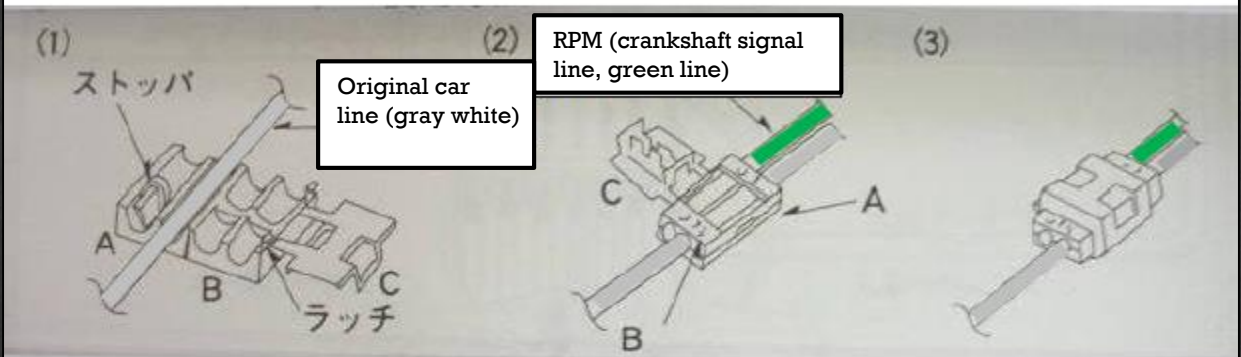

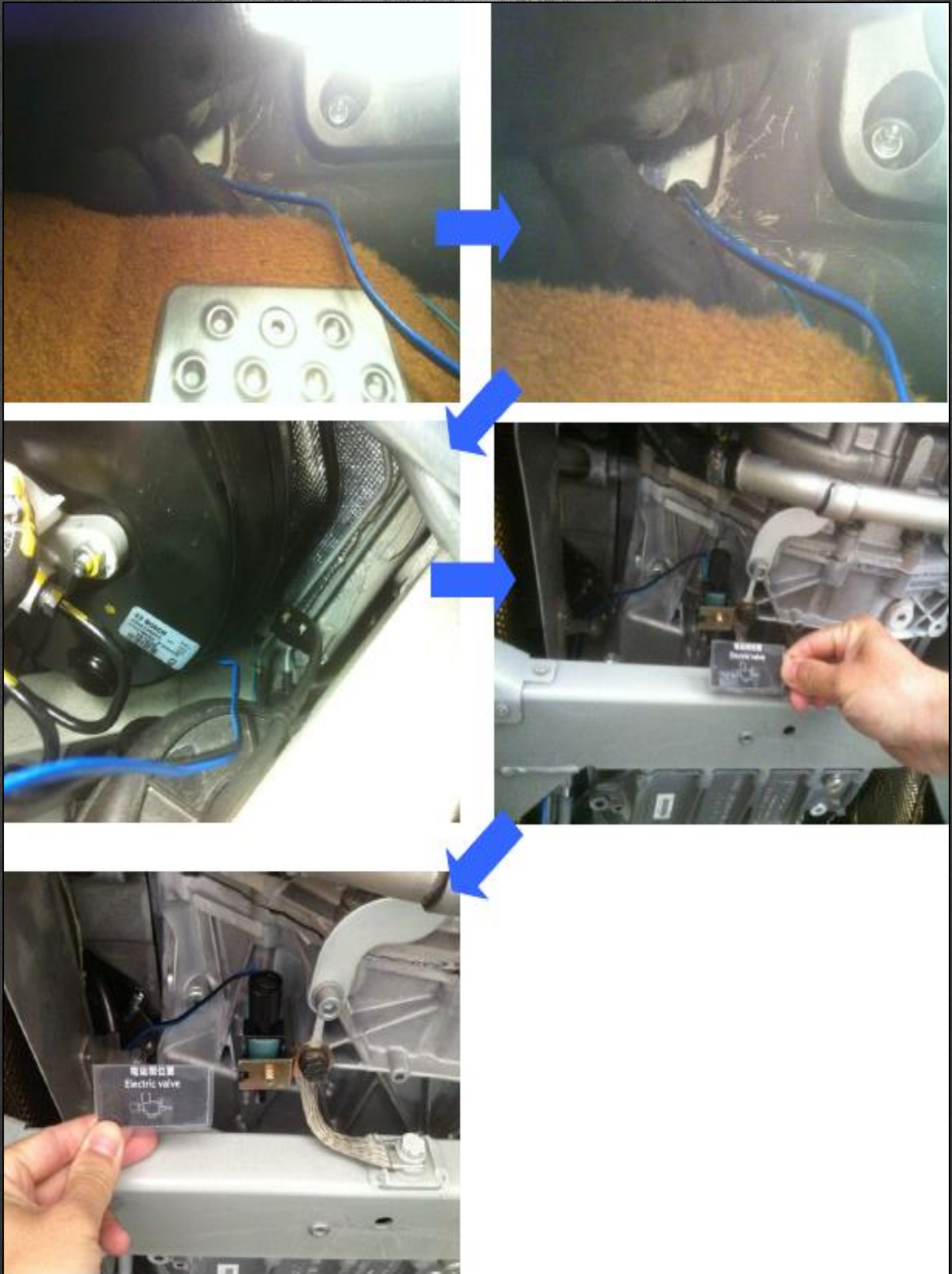



Inside the left rear wheel

